



**LT 系列高压电磁阀**  
LT Series Solenoid Valve



产品结构为加强截止式，使用压力高，安全可靠，已广泛应用于吹瓶机等高压气动系统中。尤其成功地应用于大容量特殊聚腰脂瓶的生产设备中。

The product construction is enforced globe type with high pressure, safe and reliability, which has been widely used in the high pressure pneumatic system, such as bottle blowing machine, especially in the successful application to the manufacturing equipments of special polyester waist bottle with large capacity.

**订购码**  
Ordering code

**LT23J**

**规格代码**  
二位三通高压电磁阀  
**Specification code**  
3/2 way solenoid valve

**D**

**控制方式**  
D: 单电控  
**Control type**  
D: Single electronic control

**8**

**接管口径**  
**Port size**  
08: G 1/4"(M12 × 1.25)  
15: G 1/2"(M20 × 1.5)

**P<sub>2</sub>**

**引导方式**  
空白: 内部先导  
P<sub>2</sub>: 外部先导  
**Guiding methods**  
Blank: internal guide  
P<sub>2</sub>: External guide

**符号**  
Symbol



**规格**  
Specifications

| 参数<br>Parameter                             | 订购码<br>Ordering code | LT23JD-8<br>LT23JD-8P2 | LT23JD-15<br>LT23JD-15P2 |
|---|----------------------|------------------------|--------------------------|
| 公称通径 mm<br>Nominal diameter                 |                      | 8                      | 15                       |
| 工作压力范围 Mpa<br>Working pressure range        |                      | 0.15~2.4               |                          |
| 换向时间 S<br>Reversing time                    |                      | ≤0.04                  | ≤0.08                    |
| 有效截面积 mm <sup>2</sup><br>Net sectional area |                      | ≥20                    | ≥60                      |
| 环境温度 °C<br>Ambient temperature              |                      | -10~55                 |                          |
| 介质温度 °C<br>Fluid temperature                |                      | -5~50                  |                          |
| 寿命 千次 / Thousands<br>Life                   |                      | ≥150                   |                          |

# 尺寸 Dimensions

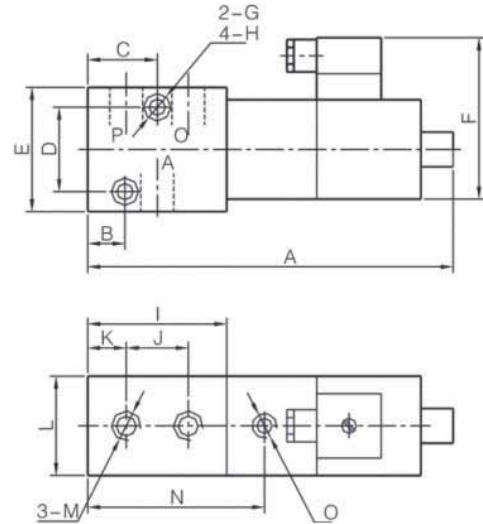
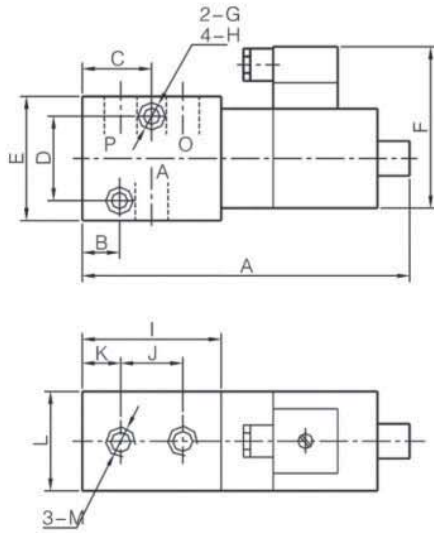

| 型号 Model   | 接管口径 Port size | A   | B  | C  | D  | E  | F  | G | H  | I  | J  | K  | L  | N  | O     |
|------------|----------------|-----|----|----|----|----|----|---|----|----|----|----|----|----|-------|
| LT23JD-8   | G1/2"          | 132 | 15 | 28 | 35 | 50 | 65 | 7 | 11 | 56 | 26 | 15 | 40 | -  | -     |
| LT23JD-8P, | G1/2"          | 145 |    |    |    |    |    |   |    |    |    |    |    | 75 | G1/8" |

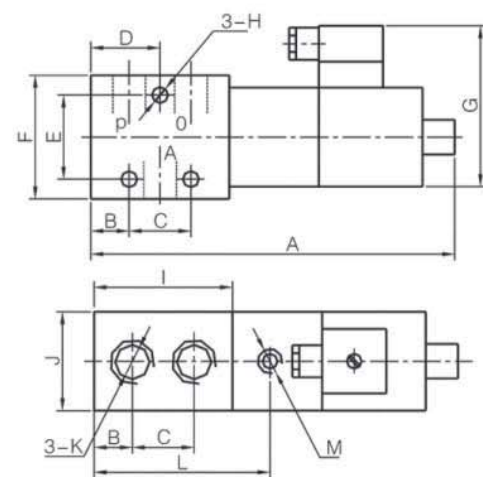
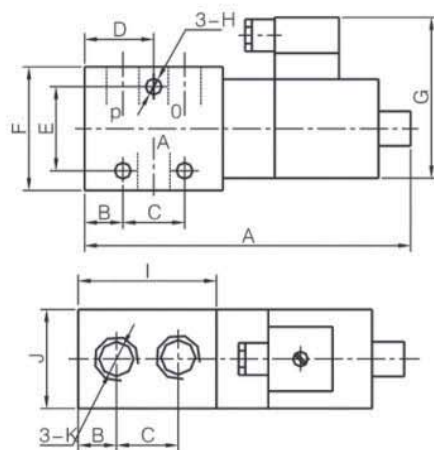

| 型号 Model   | 接管口径 Port size | A   | B  | C  | D    | E  | F  | G  | H | I  | J  | L    | M     |
|------------|----------------|-----|----|----|------|----|----|----|---|----|----|------|-------|
| LT23JD-8   | G1/2"          | 140 | 15 | 35 | 32.5 | 40 | 60 | 65 | 7 | 65 | 40 | -    | -     |
| LT23JD-8P, | G1/2"          | 157 |    |    |      |    |    |    |   |    |    | 84.5 | G1/8" |